

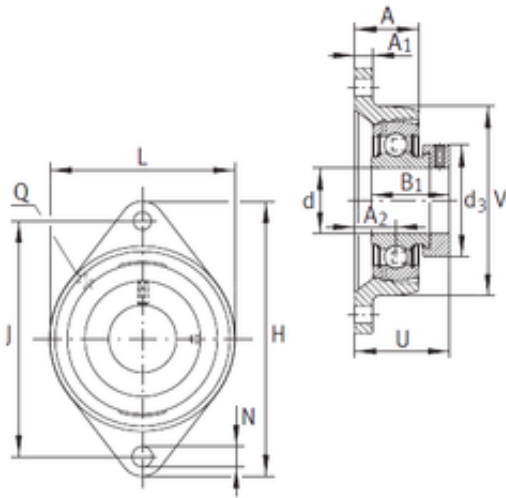

# KFY MANUFACTURING MEXICO LIMITED

## INA PCJT20-N bearing units



PCJT20-N Bearing 2D drawings and 3D CAD models

Bearing No. PCJT20-N

|                               |                       |
|-------------------------------|-----------------------|
| Bore Diameter                 | 20 mm                 |
| d                             | 20 mm                 |
| V                             | 61 mm                 |
| U                             | 42,5 mm               |
| Thread (Q)                    | Rp1/8                 |
| d3                            | 33 mm                 |
| A                             | 28 mm                 |
| A1                            | 10 mm                 |
| B1                            | 31 mm                 |
| H                             | 112 mm                |
| J                             | 90 mm                 |
| L                             | 61 mm                 |
| N                             | 11,5 mm               |
| A2                            | 19 mm                 |
| Weight                        | 0,48 Kg               |
| Basic dynamic load rating (C) | 12,8 kN               |
| Category                      | Flange Block Bearings |
| Inventory                     | 0.0                   |
| Manufacturer Name             | SCHAEFFLER GROUP      |
| Minimum Buy Quantity          | N/A                   |
| Weight / Kilogram             | 0.575                 |
| EAN                           | 4012802837582         |
| Product Group                 | M06110                |
| Number of Mounting Holes      | 2                     |
| Mounting Method               | Eccentric Collar      |
| Housing Style                 | 2 Bolt Flange Block   |



## KFY MANUFACTURING MEXICO LIMITED

|                                    |  |
|------------------------------------|--|
| Rolling Element                    | Ball Bearing   |
| Housing Material                   | Cast Iron  |
| Expansion / Non-expansion          | Non-expansion  |
| Mounting Bolts                     | 11.5 Millimeter  |
| Relubricatable                     | Yes  |
| Insert Part Number                 | GRAE20NPPB   |
| Seals                              | Double Lip Contact   |
| Housing Configuration              | 1 Piece Solid  |
| Pilot Configuration                | No Pilot   |
| Inch - Metric                      | Metric   |
| Long Description                   | 2 Bolt Flange Block; 20MM Bore; 90MM Bolt Circle; 90MM Bolt Spacing; 1 Piece Solid; Eccentric Collar Mount; Cast Iron; Ball Bearing; 31MM Length Thru Bore; Relubricatable; Double Lip Contact Seals |
| Other Features                     | Single Row   With Set Screw  |
| Category                           | Flange Block   |
| UNSPSC                             | 31171501   |
| Harmonized Tariff Code             | 8483.20.40.40  |
| Noun                               | Bearing  |
| Keyword String                     | Flanged  |
| Manufacturer URL                   | <a href="http://www.ina.com">http://www.ina.com</a>  |
| Manufacturer Item Number           | PCJT20N  |
| Weight / LBS                       | 1.103  |
| Cartridge Pilot Depth              | 0 Inch   0 Millimeter  |
| Bore                               | 0.787 Inch   20 Millimeter   |
| Cartridge Pilot Diameter           | 0 Inch   0 Millimeter  |
| Bolt Spacing                       | 3.543 Inch   90 Millimeter   |
| Length Thru Bore                   | 1.22 Inch   31 Millimeter  |
| Nominal Bolt Circle Diameter Round | 3.5 Inch   90 Millimeter   |