

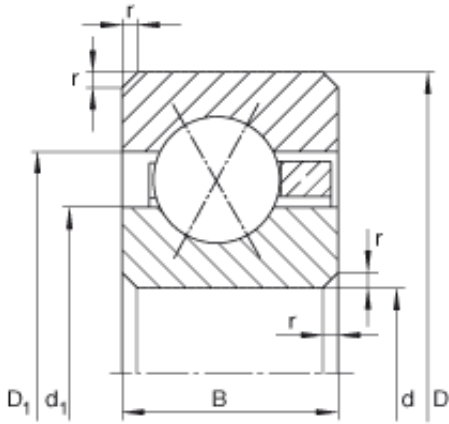

KFY MANUFACTURING MEXICO LIMITED

6 inch x 177,8 mm x 12,7 mm INA CSXD060
deep groove ball bearings



Bearing No. CSXD060

Size	152.4x177.8x12.7 mm
Bore Diameter	152,4 mm
Outer Diameter	177,8 mm
Width	12,7 mm
d	152,4 mm
d	6 inch
D	177,8 mm
B	12,7 mm
D ₁	168,4 mm
d ₁	161,8 mm
r _{min}	1,5 mm
m	0,53 kg / Weight
C _r	18900 N / Dynamic load rating (radial)
C _{0r}	30500 N / Static load rating (radial)

CSXD060 Bearing 2D drawings and 3D CAD models