

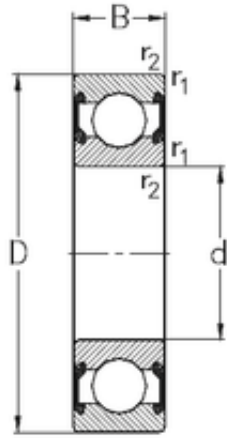

KFY MANUFACTURING MEXICO LIMITED



10 mm x 26 mm x 8 mm NKE 6000-2RS2 deep groove ball bearings

Bearing No. 6000-2RS2

Size	10x26x8 mm
Bore Diameter	10 mm
Outer Diameter	26 mm
Width	8 mm
d	10 mm
D	26 mm
B	8 mm
C	8 mm
r1 min.	0,3 mm
r2 min.	0,3 mm
Weight	0,019 Kg
Basic dynamic load rating (C)	4,6 kN
Basic static load rating (C0)	2 kN

6000-2RS2 Bearing 2D drawings and 3D CAD models