

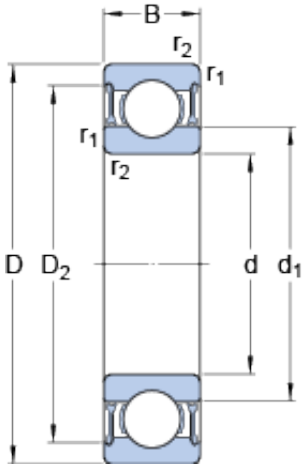

KFY MANUFACTURING MEXICO LIMITED



35 mm x 55 mm x 10 mm SKF 61907-2RZ deep groove ball bearings

Bearing No. 61907-2RZ

61907-2RZ Bearing 2D drawings and 3D CAD models

Size	55x35x10 mm
Bore Diameter	35 mm
Outer Diameter	55 mm
Width	10 mm
d	35 mm
D	55 mm
B	10 mm
d ₁	42.2 mm
D ₂	52.15 mm
r _{1,2} - min.	0.6 mm
d _a - min.	38.2 mm
d _a - max.	41.5 mm
D _a - max.	51.8 mm
r _a - max.	0.6 mm
Basic dynamic load rating - C	10.8 kN
Basic static load rating - C ₀	7.8 kN
Fatigue load limit - P _u	0.325 kN
Reference speed	26000 r/min
Limiting speed	13000 r/min
Calculation factor - k _r	0.02
Calculation factor - f ₀	15.7
Category	Single Row Ball Bearings
Inventory	3.0
Manufacturer Name	SKF



KFY MANUFACTURING MEXICO LIMITED

Minimum Buy Quantity	N/A
Weight / Kilogram	0.09
Product Group	B00308
Enclosure	2 Seals
Precision Class	ABEC 1 ISO P0
Maximum Capacity / Filling Slot	No
Rolling Element	Ball Bearing
Snap Ring	No
Internal Special Features	No
Cage Material	Steel
Enclosure Type	Non-Contact Seal
Internal Clearance	C0-Medium
Inch - Metric	Metric
Long Description	35MM Bore; 55MM Outside Diameter; 10MM Outer Race Diameter; 2 Seals; Ball Bearing; ABEC 1 ISO P0; No Filling Slot; No Snap Ring; No Internal Special Features
Category	Single Row Ball Bearing
UNSPSC	31171504
Harmonized Tariff Code	8482.10.50.68
Noun	Bearing
Keyword String	Ball
Manufacturer URL	http://www.skf.com
Manufacturer Item Number	61907-2RZ
Weight / LBS	0.19
Outside Diameter	2.165 Inch 55 Millimeter
Outer Race Width	0.394 Inch 10 Millimeter
Bore	1.378 Inch 35 Millimeter
bore diameter:	35 mm
static load capacity:	7.8 kN



KFY MANUFACTURING MEXICO LIMITED

outside diameter:	55 mm
precision rating:	Not Rated
overall width:	10 mm
finish/coating:	Uncoated
bore type:	Round
cage material:	Steel
closure type:	Double Sealed
outer ring width:	10 mm
row type & fill slot:	Single Row Non-Fill Slot
fillet radius:	0.6 mm
internal clearance:	C0
maximum rpm:	13000 RPM
operating temperature range:	-40 to +210 ° F
series:	61
dynamic load capacity:	10.8 kN
d_1	42.2 mm
D_2	52.15 mm
$r_{1,2}$ min.	0.6 mm
d_a min.	38.2 mm
d_a max.	41.5 mm
D_a max.	51.8 mm
r_a max.	0.6 mm
Basic dynamic load rating C	10.8 kN
Basic static load rating C_0	7.8 kN
Fatigue load limit P_u	0.325 kN
Calculation factor k_r	0.02
Calculation factor f_0	15.7
Mass bearing	0.08 kg