

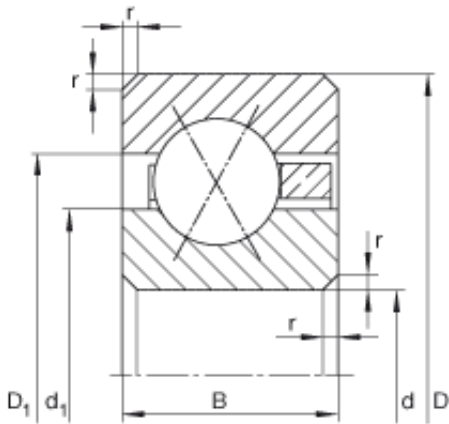

# KFY MANUFACTURING MEXICO LIMITED

16 inch x 457,2 mm x 25,4 mm INA CSXG160 deep groove ball bearings

Bearing No. CSXG160



CSXG160 Bearing 2D drawings and 3D CAD models

Size	406.4x457.2x25.4 mm
Bore Diameter	406,4 mm
Outer Diameter	457,2 mm
Width	25,4 mm
d	406,4 mm
d	16 inch
D	457,2 mm
B	25,4 mm
D <sub>1</sub>	438,4 mm
d <sub>1</sub>	425,3 mm
r <sub>min</sub>	2 mm
m	5,58 kg / Weight
C <sub>r</sub>	82000 N / Dynamic load rating (radial)
C <sub>0r</sub>	195000 N / Static load rating (radial)