

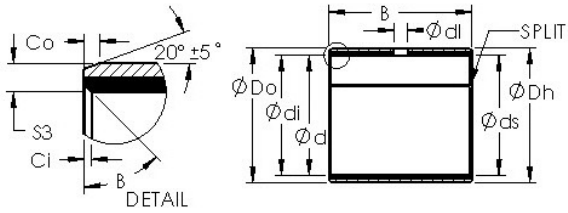

KFY MANUFACTURING MEXICO LIMITED



AST AST50 761B60 plain bearings

Bearing No. AST50 761B60

Bore Diameter	120,65 mm
Bearing Type	straight
Shaft Dia., Nominal (d)	4.7500
Shaft Size (ds) - 4.75	4.7478
Housing Bore Dia. (Dh) - 4.9374	4.9358
Bearing Bore after Mounting (di) - 4.7572	4.7502
Average Clearance (Cd)	0.0048
Wall Thickness (S3)	0.095
Bearing Length, Nominal (B)	3.750
Bearing Length Tolerance (B tol.) - +.010 / -0.010	+.010 / 0.010
OD Chamfer Length (Co)	0.072
ID Chamfer Angle (B deg.)	30
ID Chamfer Length (Ci)	0.031
Material	Carbon steel shell with PTFE / Fiber lining

AST50 761B60 Bearing 2D drawings and 3D CAD models