

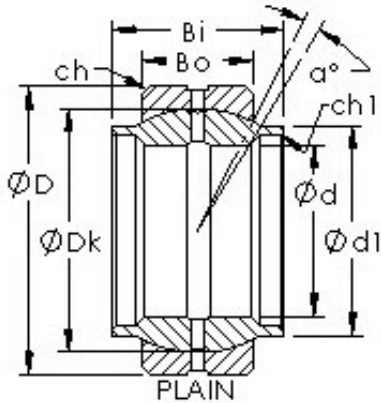

KFY MANUFACTURING MEXICO LIMITED



AST GEEW20ES plain bearings

Bearing No. GEEW20ES

Bore Diameter	20 mm
Outer Diameter	35 mm
Bearing Type	plain
Bore Dia (d)	20.0000
Outer Dia (D)	35.0000
Outer Width (Bo)	12.0000
Inner Width (Bi)	20.0000
Dynamic Load Rating (Cr)	30,000
Static Load Rating (Cor)	146,000
Max. shaft corner radius, or 45 deg. chamfer (ch1)	0.300
Max. housing corner radius, or 45 deg. chamfer (ch)	0.300
Spherical Diameter (dk or Dk)	29.000
Mis-alignment Angle (a deg.)	4
Extended Inner OD (d1)	25.000
Weight (g)	69.00
Material	52100 Chrome steel, or equivalent

GEEW20ES Bearing 2D drawings and 3D CAD models