

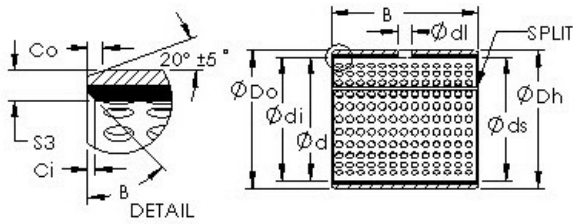

KFY MANUFACTURING MEXICO LIMITED



AST AST20 30IB30 plain bearings

Bearing No. AST20 30IB30

Bore Diameter	47,625 mm
Outer Diameter	52,4 mm
Bearing Type	straight
Shaft Dia., Nominal (d)	1.8750
Shaft Size (ds)	1.8632 / 1.8616
Housing Bore Dia. (Dh)	2.0637 / 2.0625
Bearing Outside Diameter, Nominal (Do)	2.063
Bearing Bore after Mounting (di)	1.8713 / 1.8665
Average Clearance (Cd)	0.0070
Wall Thickness (S3)	0.098
Bearing Length, Nominal (B)	1.875
Bearing Length Tolerance (B tol.) - +.010 / -0.010	+0.010 / 0.010
OD Chamfer Length (Co)	0.070
ID Chamfer Angle (B deg.)	45
ID Chamfer Length (Ci)	0.031
Lube Hole Dia. (dl)	0.313
Material	Carbon steel shell with POM plastic liner

AST20 30IB30 Bearing 2D drawings and 3D CAD models