

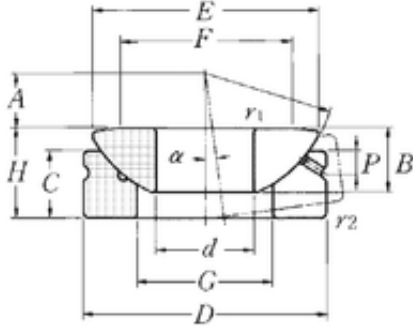

KFY MANUFACTURING MEXICO LIMITED

35 mm x 90 mm x 22 mm NTN SAT35 plain bearings



Bearing No. SAT35

SAT35 Bearing 2D drawings and 3D CAD models

Size	35x90x22 mm
Bore Diameter	35 mm
Outer Diameter	90 mm
Width	22 mm
d	35 mm
D	90 mm
B	22 mm
C	20 mm
H	28 mm
P	8 mm
r1 min.	0,6 mm
r2 min.	1 mm
A	22 mm
E	84 mm
F	66 mm
G	52 mm
Angle	5 °
Weight	1,02 Kg
Basic dynamic load rating (C)	254 kN
Category	Bearings
Inventory	0.0
Manufacturer Name	NTN
Minimum Buy Quantity	N/A
Weight / Kilogram	1.04
Product Group	B04264



KFY MANUFACTURING MEXICO LIMITED